

YOU AND ME PANEL QUILT

Riley Blake
DESIGNS[®]

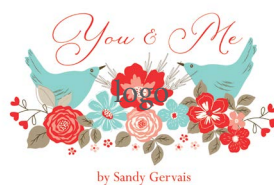

45 1/2" x 53 1/2"



 = Confident Beginner

11/01/2024

YOU AND ME PANEL QUILT

FINISHED QUILT SIZE 45 ½" × 53 ½"

Please read all instructions before beginning this project.
Yardage calculated using a 42" usable width of fabric.

Pattern designed by The RBD Designers.

GENERAL INSTRUCTIONS

Please check www.rileyblakedesigns.com/pattern-updates or scan the QR Code for any revisions before starting this project. This pattern requires a basic knowledge of quilting techniques and terminology. The quilt and block diagrams portrayed are virtual images. The layout and look of your project may differ when using actual fabric. It is not recommended to prewash fabric before cutting and assembling.



Always verify your panel size before beginning. If your panel measurements differ from those given in the pattern, trim to the desired size or use coping strips to alter the size of your panel. If coping strips are needed, add oversized, coordinating strips of fabric to the necessary edges of the panel, then trim to the size specified in the pattern.

WOF = Width of Fabric

RST = Right Sides Together

SNF = Stitch and Flip

FABRIC REQUIREMENTS

All fabrics from the You & Me collection unless stated otherwise.

- (1) PD15407-PANEL You & Me Panel
- ½ yard C15405-AQUA Hearts Grid
- ½ yard C15406-CREAM Plaid
- ¾ yard C15405-RED Hearts Grid (binding)

OTHER SUPPLIES

- Basic Sewing Supplies
- 1 ½ yards WB14183-SCHOOL Bee Dots Wide Back Backing
- Batting

CUTTING INSTRUCTIONS

When cutting fabrics, use a straight edge ruler and rotary cutter. Measurements include ¼" seam allowance. Label, allocate, and organize all cuts as noted.



You and Me Panel

Fussy cut (1) panel 34 ½" × 42 ½", centered over the motif.*

**Note: If the panel motif does not reach the edge of the required cut, add coping strips first and then trim to the required size once the strips are added.*

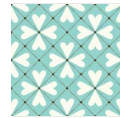

Aqua Hearts Grid

Cut (4) 3" × WOF strips; subcut:

(4) 3" × 19 ½" strips. Label as A.

(4) 3" × 15 ½" strips. Label as B.

(8) 3" × 3" squares. Label as C.

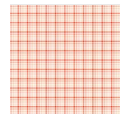

Cream Plaid

Cut (4) 3" × WOF strips; subcut:

(4) 3" × 19 ½" strips. Label as D.

(4) 3" × 15 ½" strips. Label as E.

(4) 2 ¼" × 2 ¾" rectangles. Label as F.

Cut (1) 1 ¾" × WOF strip; subcut:

(16) 1 ¾" × 1 ¾" squares. Label as G.

(8) 1" × 1" squares. Label as H.

Cut (1) 1" × WOF strip; subcut:

(4) 1" × 5 ½" rectangles. Label as I.

(4) 1" × 5" rectangles. Label as J.

YOU AND ME PANEL QUILT



Red Hearts Grid

- Cut (1) $3 \frac{1}{8}$ " \times WOF strip; subcut:
- (4) $3 \frac{1}{8}$ " \times 5" rectangles. Label as K.
 - (4) 3 " \times $5 \frac{1}{2}$ " rectangles. Label as L.
- Cut (1) 3" \times WOF strip; subcut:
- (4) 3 " \times $5 \frac{1}{2}$ " rectangles. Label as L.
 - (4) $2 \frac{3}{8}$ " \times $3 \frac{1}{4}$ " rectangles. Label as M.
- Cut (6) $2 \frac{1}{2}$ " \times WOF strips. Set aside for binding.
- Cut (4) 1" \times WOF strips. Piece end-to-end; subcut:
- (2) 1" \times $42 \frac{1}{2}$ " strips. Label as N.
 - (2) 1" \times $35 \frac{1}{2}$ " strips. Label as O.

SEWING TECHNIQUES

Sew all seams RST and with a $\frac{1}{4}$ " seam allowance unless stated otherwise. Refer to the quilt layout diagram for placement of the prints. Press seams as desired unless stated otherwise. Dimensions listed in steps are unfinished sizes. Please refer to the following general sewing technique as this method is referenced throughout the pattern in its abbreviated form.

STITCH AND FLIP METHOD (SNF)

Place (2) pieces RST, matching raw edges in the corner to be replaced. Draw a diagonal line on the wrong side of the smaller piece across the corner. Stitch on the drawn line. Trim the seam allowance outside the sewn line to $\frac{1}{4}$ ". Flip the smaller piece away from the larger piece and press, replacing the corner. The size of the larger, original piece does not change.

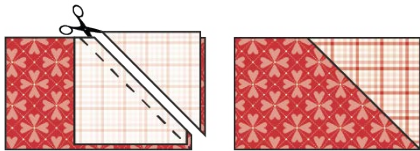

BLOCK ASSEMBLY

1. Gather (1) **H**-square and (1) **K**-rectangle, and use the SNF method to make the unit shown below, referencing the diagram for proper placement and orientation. Repeat to make (4) total Corner Heart 1 Units. Set aside.

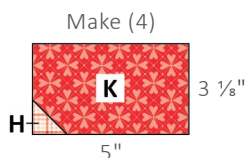

2. Gather (1) **F**-rectangle, (1) **H**-square, and (1) **M**-rectangle. Use the SNF method to sew the **H**-square to the top right corner of the **M**-rectangle. Next, sew the **F**-rectangle to the left of the SNF unit, referencing the diagram for proper placement and orientation. Repeat to make (4) total Corner Heart 2 Units.

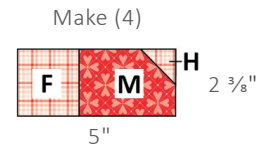

3. Gather (1) Corner Heart 1 Unit and (1) Corner Heart 2 Unit. Sew together, referencing the diagram for proper placement and orientation. Press. Repeat to make (4) total Corner Heart 3 Units.

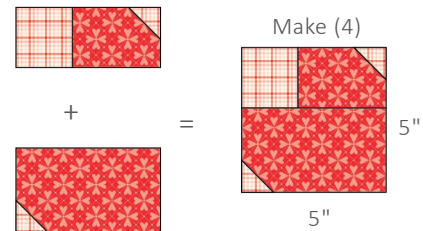

4. Gather (1) Corner Heart 3 Unit, (1) **I**-rectangle, and (1) **J**-rectangle. Sew the **J**-rectangle to the top of the Corner Heart 3 Unit. Press. Then sew the **I**-rectangle to the left side of the Corner Heart 3 Unit. Press. Repeat to make (4) total Corner Heart Blocks. Set aside.

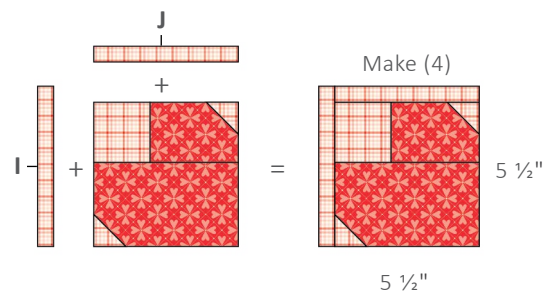

5. Gather (4) **G**-squares, (2) **C**-squares, and (2) **L**-rectangles. Use the SNF method to make the units shown below, referencing the diagrams for proper placement and orientation. Repeat to make (4) total Right Heart Units and (4) total Left Heart Units.

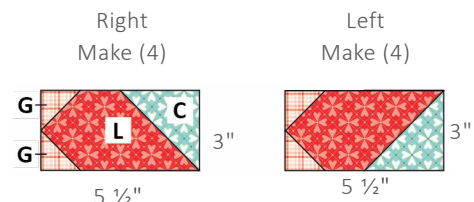

YOU AND ME PANEL QUILT

6. Gather (1) Left Heart Unit and (1) Right Heart Unit. Sew together, referencing the diagram for proper placement and orientation. Press. Repeat to make (4) total Strip Heart Blocks. Set aside.

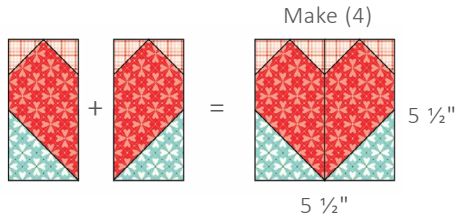

10. Gather (2) Top/Bottom Border Units, (2) Corner Heart Blocks, and (1) Strip Heart Block. Sew together, referencing the diagram for proper placement and orientation. Press. Repeat to make (2) total Top/Bottom Borders. Set aside.

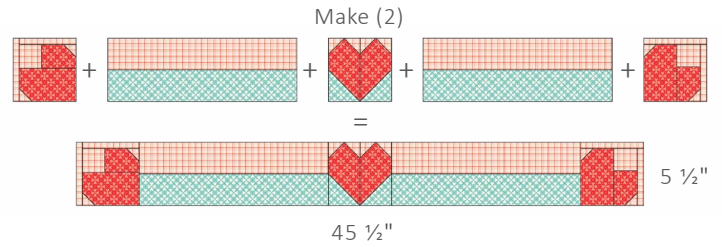

QUILT ASSEMBLY

7. Gather (1) **A**-strip and (1) **D**-strip. Sew together, referencing the diagram for proper placement and orientation. Press. Repeat to make (4) total Side Border Units.

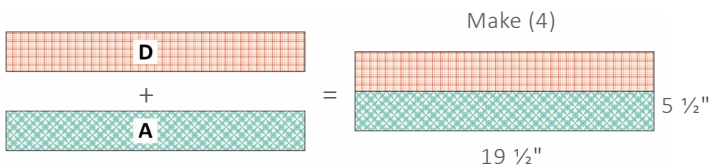

8. Gather (2) Side Border Units and (1) Strip Heart Block. Sew together, referencing the diagram for proper placement and orientation. Press. Repeat to make (2) total Side Borders. Set aside.

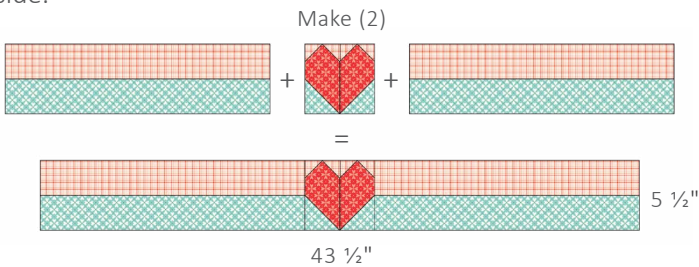

9. Gather (1) **B**-strip and (1) **E**-strip. Sew together, referencing the diagram for proper placement and orientation. Press. Repeat to make (4) total Top/Bottom Border Units.

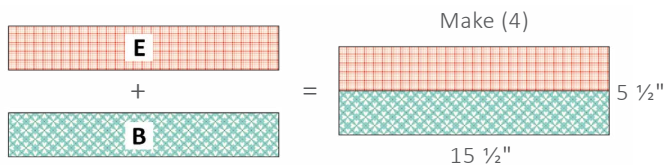

11. Sew the **N**-strips to the sides of the Panel, then the **O**-strips to the top and bottom of the panel. Next, sew the Side Borders to the sides of the quilt center and the Top/Bottom Borders to the top and bottom of the quilt center, referring the diagram for orientation of the borders.

QUILT LAYOUT DIAGRAM

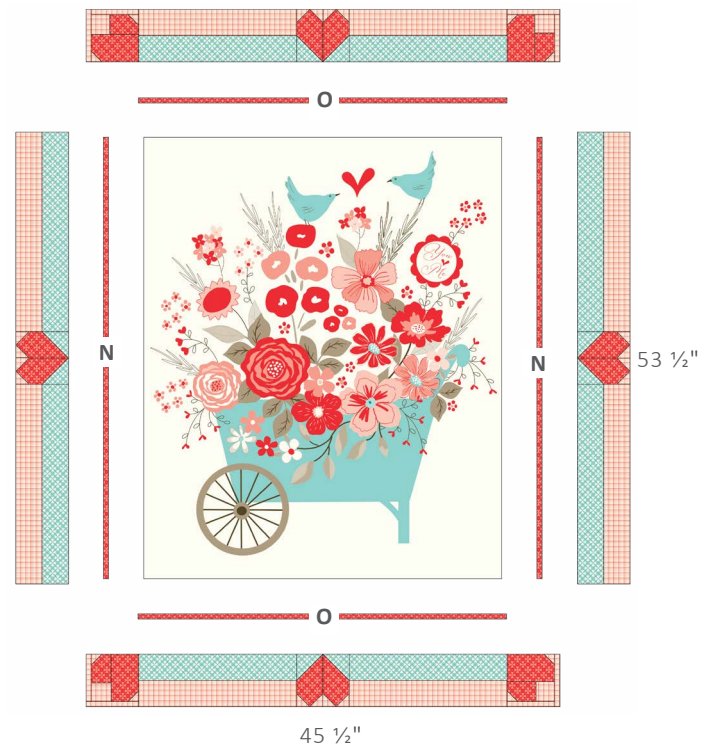

FINISHING INSTRUCTIONS

12. Finish the quilt by layering the quilt top, batting, and backing. Baste the quilt layers together and quilt as desired. Sew the Red Hearts Grid binding strips together end-to-end. Then bind the trimmed, finished quilt using your favorite binding method.

Enjoy and share your quilt using the hashtags [#youandmefabric](#), [#youandmepanelquilt](#), [#rileyblakedesigns](#), and [#iloverileyblake](#).