

SUNSHOWERS

Riley Blake
DESIGNS®



88 ½" x 88 ½"

Expressions
Batiks by Riley Blake Designs™



= Beginner

08/01/2024

SUNSHOWERS

FINISHED QUILT SIZE 88 ½" x 88 ½"

Please read all instructions before beginning this project.
Yardage calculated using a 42" usable width of fabric.
Pattern designed by The RBD Designers.

GENERAL INSTRUCTIONS

Please check www.rileyblakedesigns.com/pattern-updates or scan the QR Code for any revisions before starting this project. This pattern requires a basic knowledge of quilting techniques and terminology. The quilt and block diagrams portrayed are virtual images. The layout and look of your project may differ when using actual fabric. It is not recommended to prewash fabric before cutting and assembling.



WOF = Width of Fabric
RST = Right Sides Together
HST = Half Square Triangle

FABRIC REQUIREMENTS

All fabrics from the Warm Rain collection unless stated otherwise.

Fat Quarters:

BT23030-298-INDIGO DYE
BT23030-315-OLIVE
BT23031-237-PAPAYA
BT23031-238-SPICE
BT23031-258-GOLDENROD
BT23031-268-AUTUMN LEAVES
BT23031-279-SMOKY TEAL
BT23031-295-LAPIS
BT23031-319-FOREST GREEN
BT23032-145-BRONZE SEA
BT23032-147-GINGER SYRUP
BT23032-148-ORGANZA
BT23032-246-MARMALADE SPLASH
BT23032-266-SANDSTORM
BT23032-288-SPILLED TEA
BT23032-296-AZURE

BT23033-137-GINGERBREAD
BT23033-233-APRICOT
BT23033-268-AUTUMN LEAVES
BT23033-294-OCEAN BLUE
BT23033-317-EMERALD
2 yards BT23032-247-CINNAMON GROVE (includes binding)
3 ⅝ yards BTHH184-CREAM

OTHER SUPPLIES

Basic Sewing Supplies
2 ⅝ yards Wide Back backing fabric of your choice
Batting

CUTTING INSTRUCTIONS

When cutting fabrics, use a straight edge ruler and rotary cutter. Measurements include ¼" seam allowance. Label, allocate, and organize all cuts as noted.

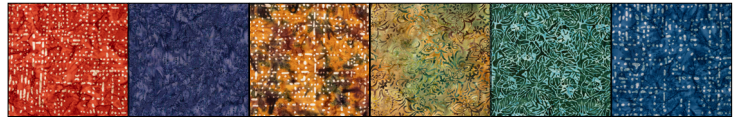

(21) Warm Rain Fat Quarters

From (11) Fat Quarters cut (10) 5" x 5" squares. Label as **A**.
From (10) Fat Quarters cut (9) 5" x 5" squares. Label as **A**.

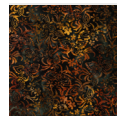

Cinammon Grove

Cut (9) 4 ½" x WOF strips. Piece together end-to-end; subcut:

(2) 4 ½" x 80 ½" strips. Label as **B**.

(2) 4 ½" x 88 ½" strips. Label as **C**.

Cut (10) 2 ½" x WOF strips for the binding.



Cream

Cut (25) 5" x WOF strips; subcut:

(200) 5" x 5" squares. Label as **D**.

SUNSHOWERS

SEWING TECHNIQUE

Sew all seams RST and with a $\frac{1}{4}$ " seam allowance unless stated otherwise. Refer to the quilt layout diagram for placement of the prints. Press seams as desired unless stated otherwise. Dimensions listed in steps are unfinished sizes. Please refer to the following general sewing technique as this method is referenced throughout the pattern in the abbreviated form.

2-AT-A-TIME HALF SQUARE TRIANGLE METHOD (HST)

Place (2) squares RST. Draw a diagonal line on the wrong side of (1) square. Stitch $\frac{1}{4}$ " on each side of the drawn line. Cut on the drawn line to create (2) HSTs. Press toward the darker fabric. Trim HSTs to the indicated size.

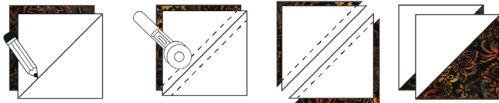

QUADRANT ASSEMBLY

Note: Refer to the quilt photo and diagrams for the placement of blocks. Press seams as shown. The quilt center is composed of (4) quadrants. Each quadrant measures (10) rows of (10) HSTs. Quadrants 1 and 4 are laid out the same and Quadrants 2 and 3 are laid out the same.

1. Use the 2-at-a-time HST method to make (400) HSTs using the **A** and **D**-squares. Trim to $4\frac{1}{2}$ " x $4\frac{1}{2}$ ".
2. Lay out (10) rows of (10) HSTs referring to the Quadrant Diagrams.
3. Sew the HSTs together into rows. Sew the rows together to complete the Quadrant.
4. Repeat to make a total of (2) Quadrant 1 units and (2) Quadrant 2 units.

QUADRANT 1/4 DIAGRAM (MAKE 2)



QUADRANT 2/3 DIAGRAM (MAKE 2)



SUNSHOWERS

QUILT ASSEMBLY

5. Lay out the quadrants following the Quadrant Identification Diagram. Sew the quadrants together into rows. Sew the rows together to complete the quilt center.

Quadrant Identification Diagram

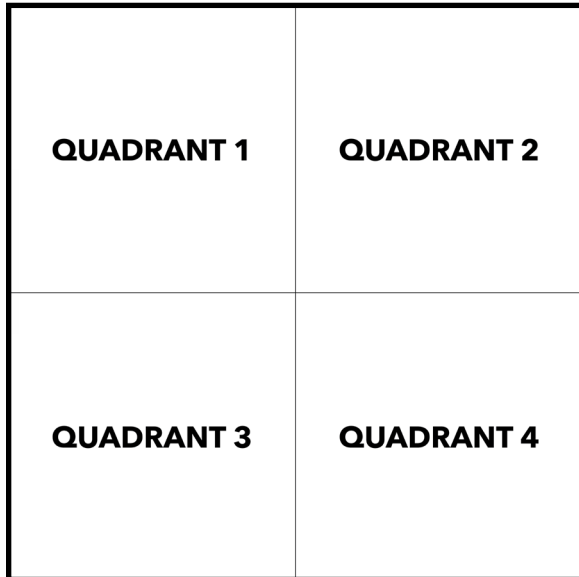

6. Sew the **B**-strips to the sides of the Quilt Center. Press toward the **B**-strips.

7. Sew the **C**-strips to the top and bottom of the Quilt Center. Press toward the **C**-strips.

FINISHING INSTRUCTIONS

8. Finish the quilt by layering the quilt top, batting, and backing. Baste the quilt layers together and quilt as desired. Sew the Cinnamon Grove binding strips together end-to-end. Then bind the trimmed, finished quilt using your favorite binding method.

Enjoy and share your quilt using the hashtags [#warmrainfabric](#), [#sunshowersquilt](#), [#rileyblakedesigns](#), and [#iloverileyblake](#).

BORDERS



SUNSHOWERS

QUILT LAYOUT DIAGRAM



88 ½" x 88 ½"